

KEY PLAN

24 M. WIDE ROAD

STREET NO. - 622

ENTRY / EXIT FOR HIG

ENTRY / EXIT FOR HIG

ENTRY / EXIT FOR MIO & LIG

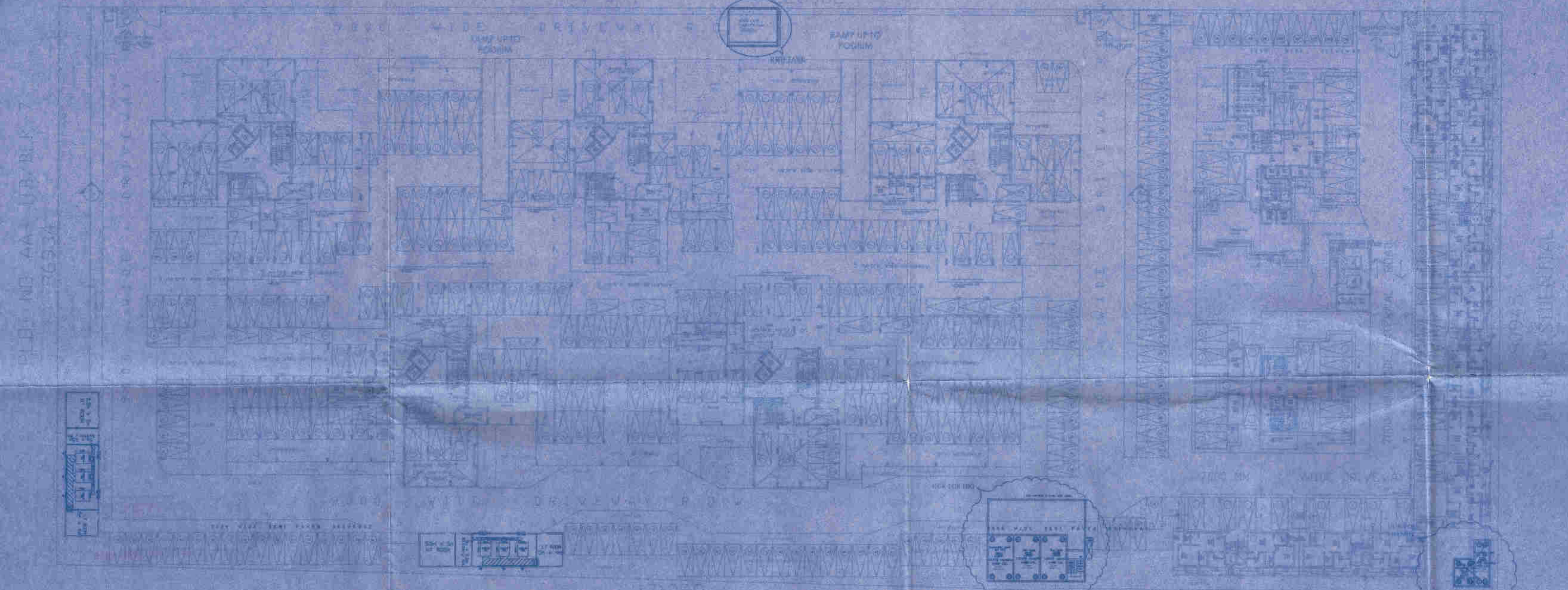

Basudeb Das
Basudeb Das
B.E. (Civil), A.C.E. (Engg.)
Consulting Public Health Engineer
PHER / NKDA / 10 / 80004

BENGAL EMAMI HOUSING LTD.
Authorized Signatory

Internal Revision	

1618 BENGAL EMAMI HOUSING LTD. KOLKATA

REV	DATE	REVISION	DESIGNED	CHECKED

OWNER: BENGAL EMAMI HOUSING LTD.
ARCHITECT: ARCHITECT UNITEE CONTRACTOR

SCALE: 1:100 REVISION: 0/8
STATUS: NKDA SUBMISSION

TITLE: UGR & RWH LOCATION
DRAWING NO: 1618/P/C/UGR/102

DATE: 20.10.15
DRAWN BY: PRASHANT B
DESIGNED BY: PRASHANT B
CHECKED BY: NISHANT C
APPROVED BY: ANAND J

Prashant B
PRAKASH SANKH
COUNCIL OF ARCHITECTS
REGD. ARCHITECT, CAT/1356

UGR & RWH LOCATION

NOTES

SR. NO	TANK	CAPACITY	WATER DEPTH
1	RWH TANK	1,70,000 LTR	4000MM

SR. NO	CAMPARTMENT	CAPACITY	WATER DEPTH
1	DOM & FLU FOR HIG	1,21,225 LTR	450MM
2	DOM & FLU FOR MIO	61,905 LTR	410MM
3	DOM & FEU FOR LIG	32,400 LTR	230MM
4	FIRE FIGHTING 1	120,000 LTR	450MM
5	FIRE FIGHTING 2	120,000 LTR	450MM

PARTY'S COPY

WATER SUPPLY LINE AVAILABLE

NOTE
THIS SANCTION IS ONLY FOR WATER SUPPLY/
SEWERAGE AND DRAINAGE LAYOUT PLAN

PIN NO : 2416/NKDA/BPS-02/2016 DT : 11.5.2016

Suganti Majumder
Assistant Architect
New Town Kolkata Development Authority

S. Chatterjee
SUKRIT CHATTERJEE
Chief Architect
New Town Kolkata Development Authority